

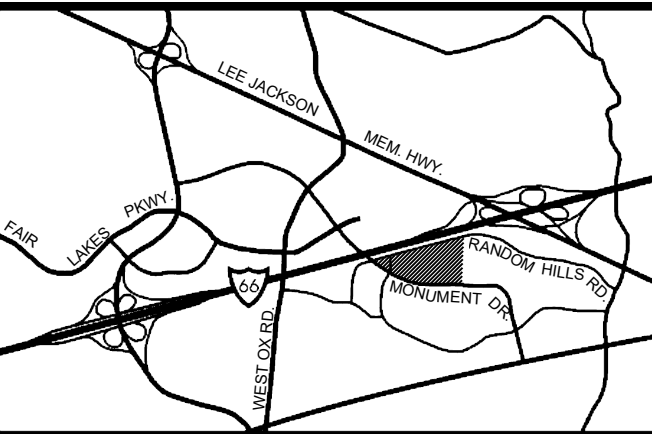

Fairfax, Virginia 22033

Project Statistics Area Tabulations

BUILDING	GLA
BUILDING B	26,025 SF
BUILDING D	130,000 SF
BUILDING E1	22,833 SF
BUILDING E2	11,059 SF
BUILDING F1	5,783 SF
BUILDING F2	13,813 SF
BUILDING G	100,000 SF
BUILDING H (1ST)	20,213 SF
BUILDING H (2ND)	20,424 SF
BUILDING J	8,020 SF
BUILDING L	9,290 SF
BUILDING M	9,211 SF
BUILDING N	24,017 SF
BUILDING O (2ND)	12,581 SF
BUILDING O (1ST)	20,439 SF
BUILDING O (2ND)	20,372 SF
BUILDING P1	20,762 SF
BUILDING Q	20,088 SF
Total GLA	495,530 SF



Vicinity Map

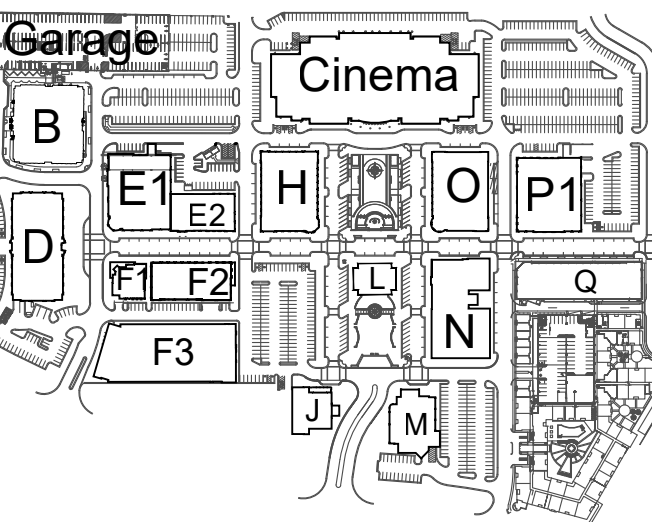

Key Plan



12500 Fair Lakes Circle Fairfax, Virginia 22033 www.petersoncos.com

LEASING AGENTS Tony Summers 301.203.4153 tsummers@petersoncos.com

Howard Jensen 703.631.7556 hjensen@petersoncos.com

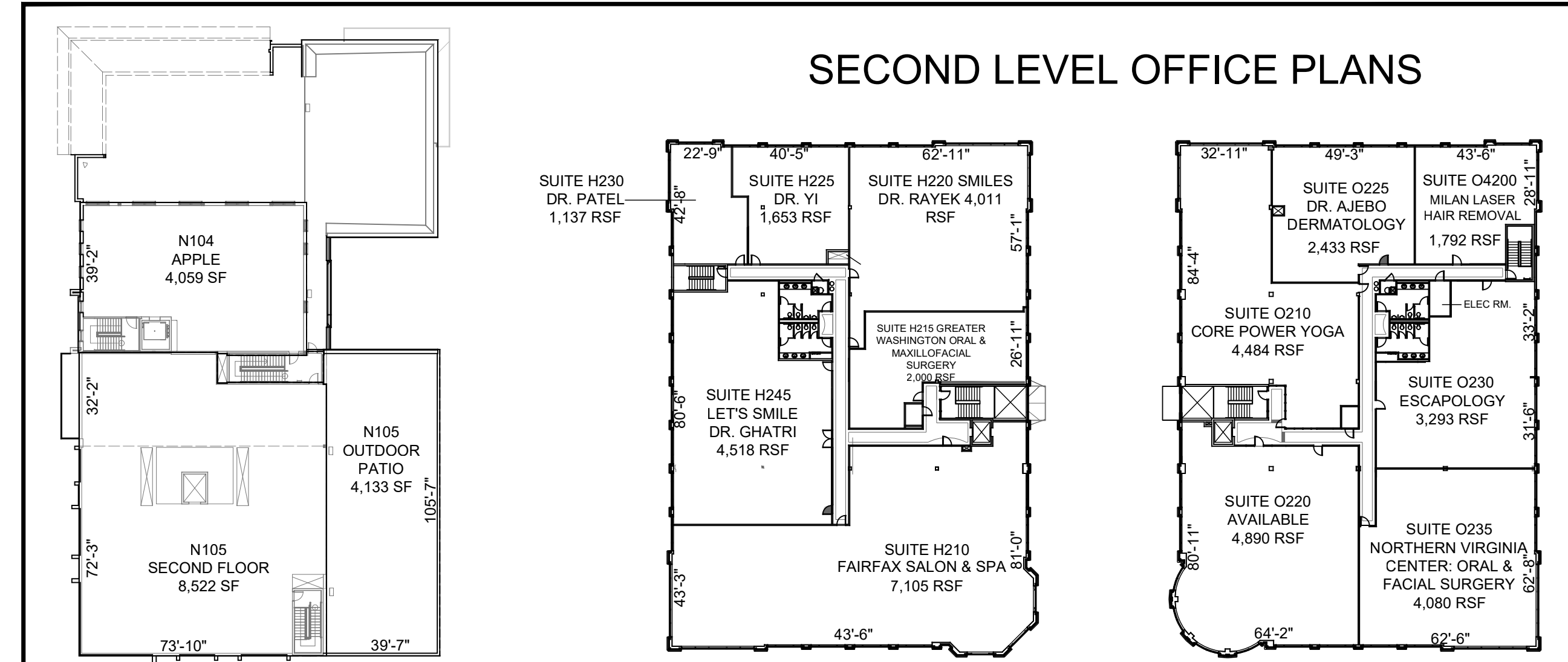
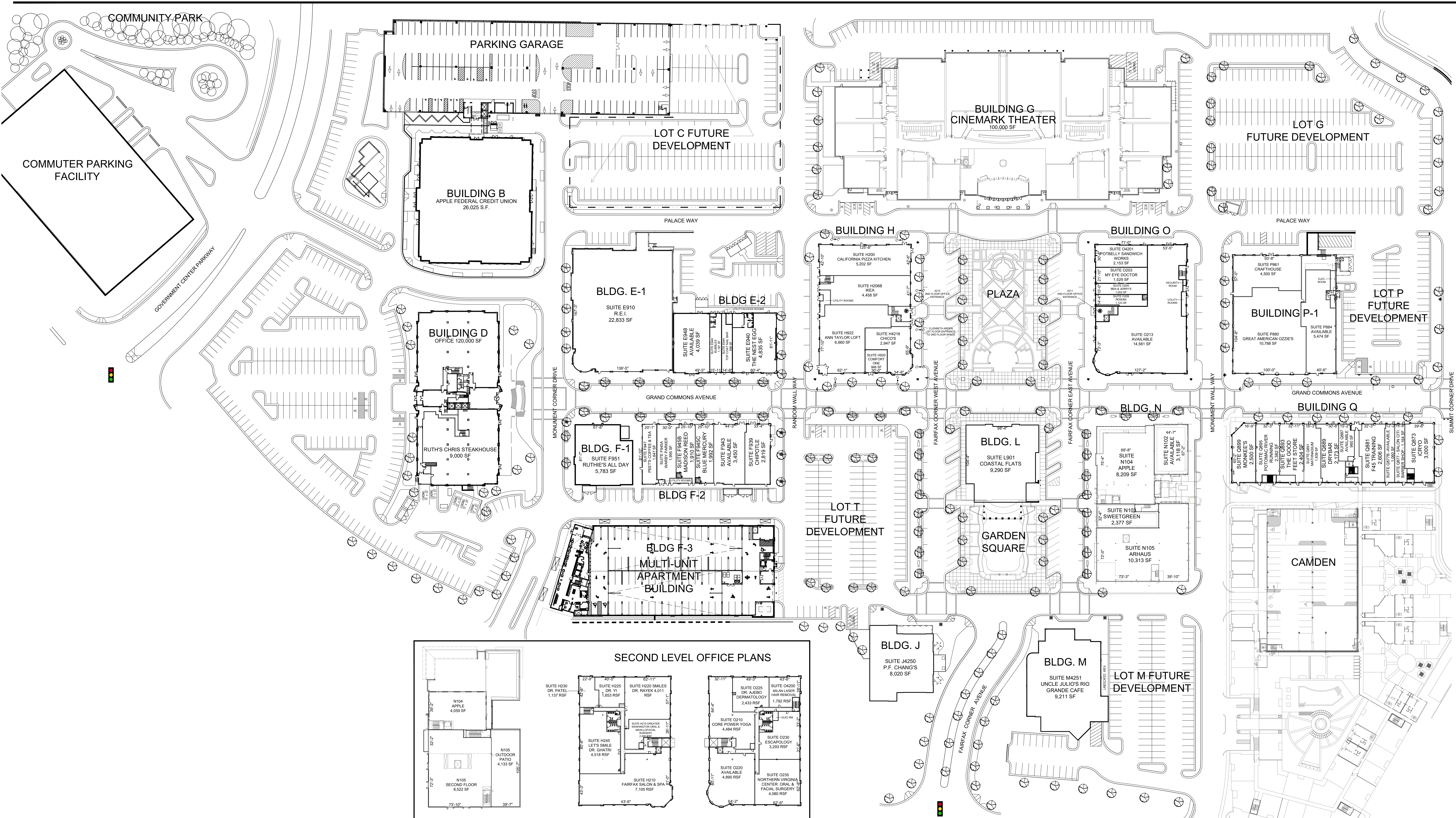

BUILDING N SECOND FLOOR BUILDING H SECOND FLOOR BUILDING O SECOND FLOOR

This site merchandising plan is for general illustrative purposes only and is not intended to show the precise leasing lines of any premises, nor the exact configuration, number, location or size of any improvements, buildings or common areas, all of which may vary from time to time subject to the limitations set forth in the Lease, if any. Any references to specific tenants or square footages on this site merchandising plan shall not constitute any representation or warranty by Landlord as to the actual tenants or square footages or as to any future tenants or square footages.

Leasing Plan